

FlightLine 5K

USAF Reserve Air Base Niagara Falls, NY



Certified Course
NY25012JJ

Effective: 7/31/2025
Through: 12/31/2035

Course Distance:	5 Km
Course Design By:	Kenneth L Dawley, SMSgt
Date Measured:	July 23, 2025
Measured By:	Jeff John, <i>BuffaloRunners.com</i>
Calibration Course:	NFHS 300 Meters, NY18006JJ
Notes:	Map not to scale. This course was measured using the full width of the road and the Shortest Possible Route (SPR).

Detailed description of START, FINISH, TURN-AROUND and every turn is provided on subsequent Map Page.

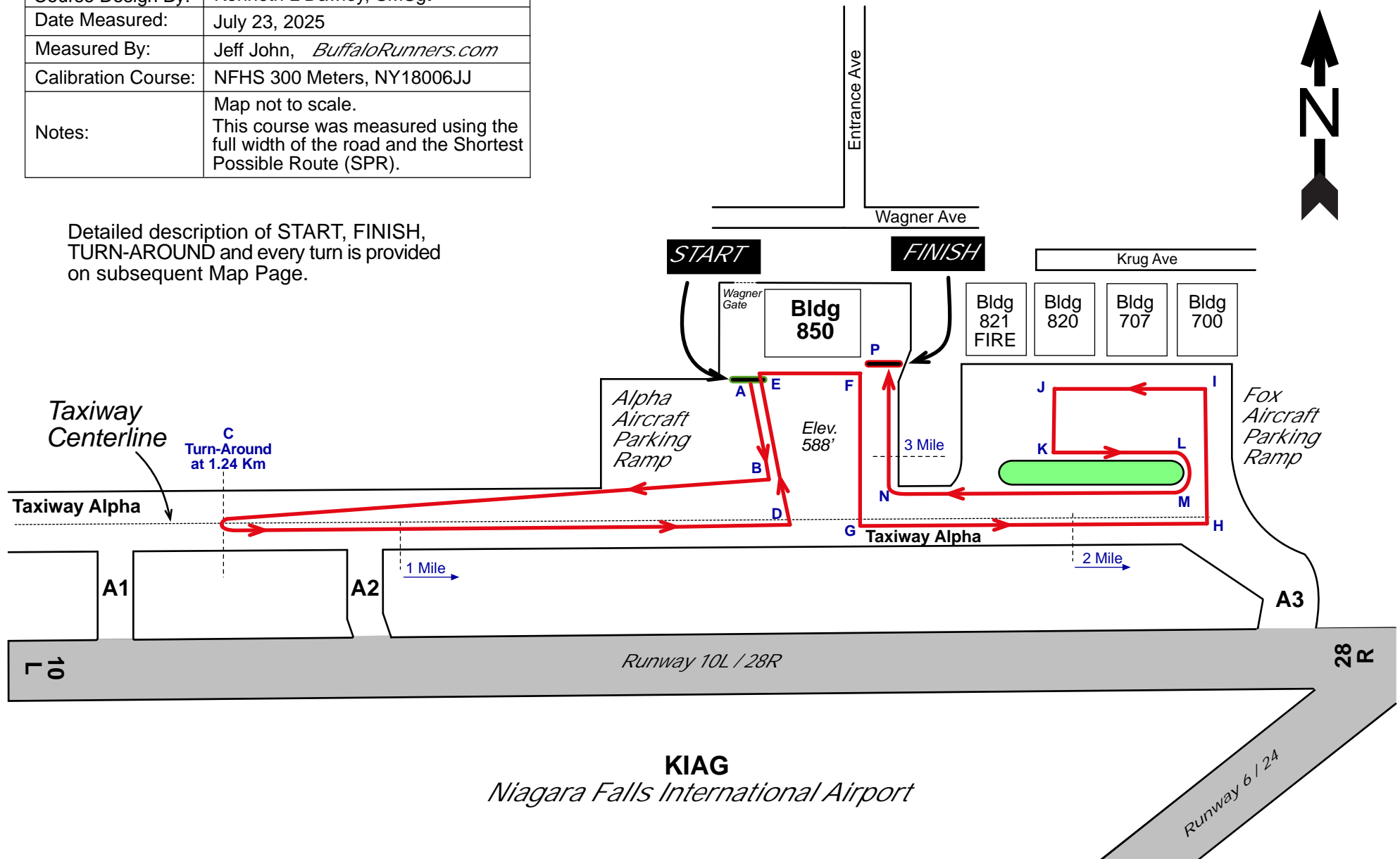

FlightLine 5K

USAF Reserve Air Base Niagara Falls, NY

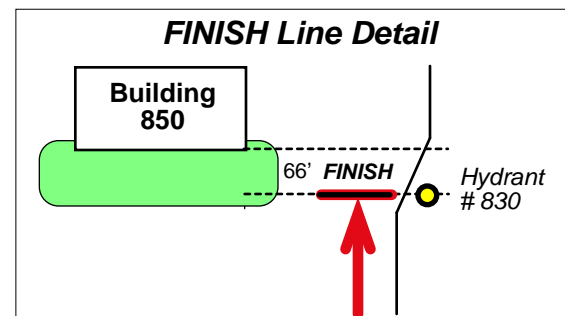
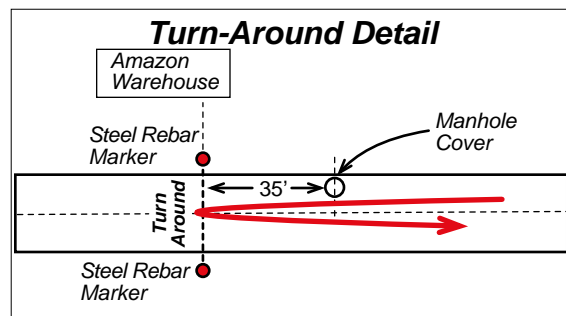
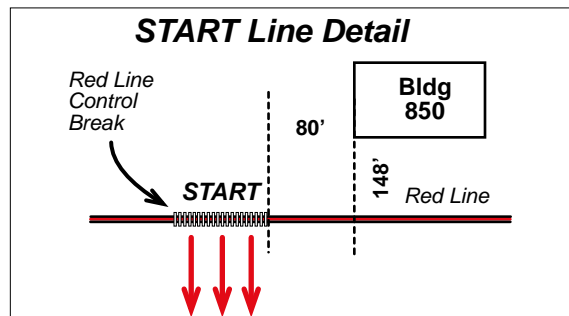

START, FINISH, Turn-Around and All Turn Locations

- A** At the control break in the Red Line near to Bldg 850, and 80' west and 148' south of the south-west corner of Bldg 850.
- B** First turn on the Alpha Ramp, Right Turn to head west, 926.25' south of and 282' west of south-east corner of Bldg 850.
- C** The Turn-Around on Taxiway Alpha to change direction from west to east, mid-way between taxiway turnoffs A1 and A2, 35' west of round manhole cover on north side of taxiway, 70 1/2 inches south of concrete expansion joint, 14' 6" west of blue taxiway lamp on north edge of taxiway, and demarked by red-tipped steel rebar rod pounded into ground at north and south edges of the taxiway at this point to further confirm the exact location.
- 1-MILE** 10' past (east of) taxiway Alpha turnout sign located between taxiway and runway, and 160' east of the A2 turnout.
- D** 977.5' south and 231.5' west of south-west corner of Bldg 850.
- E** 2.5 Km. Same line as the Start Line, At the control break in the east-west Red Line near to Bldg 850, and 80' west and 148' south of the south-west corner of Bldg 850.
- F** Right turn to run south toward the taxiway, 136' south of Bldg 850 and in-line with the east edge of Bldg 850.
- G** Make left turn to run east on taxiway, 980' south of south edge of bldg 850.
- H** Make left turn to enter Fox Ramp, 11' east of east edge of Bldg 700, and 567' south of south edge of Bldg 700.
- I** Make left turn to run west into the Fox Ramp, 145' south of Bldg 700 and 11' east of east edge of Bldg 700.
- J** Make left turn to run south, 16' west of the east edge of Bldg 820 Bldg 820, red-tipped steel rebar planted at north and south sides of ramp at this location to aid in locating the exact point.
- K** Make left turn to run east, 181' south of Point "J" or 370' south of south edge of Bldg 821 (Fire Dept). red-tipped steel rebar planted at north and south sides of ramp at this location to aid in locating the exact point.
- L** Make right turn to run south to exit the Fox Ramp at 348' south of south edge of Bldg 700, and 885' beyond point "K". Runners may take SPR with grass medians to their right from this point thru the Finish Line but keeping the Taxiway center line to their left to avoid runner conflicts.
- M** Make right turn following curve of median onto Taxiway Alpha west bound.
- N** Make right turn following curve of median onto Alpha Ramp and north bound all the way to Finish Line.
- P** Finish Line, exactly at Mueller Fire Hydrant # 830 on east edge of Alpha Ramp and 66' south and 110' east of the south-east corner of Bldg 850.